

INSTALLATION GUIDE

AMP RESEARCH Power Step

MADE IN USA

APPLICATION	MODEL YR	PART #
Toyota Tundra Double Cab *	2007 - up	75137-01A
Toyota Tundra CrewMax	2007 - up	75137-01A
Toyota Sequoia *	2008 - up	75137-01A

***Modification required to running board assembly. See Item 1 on page 2.**

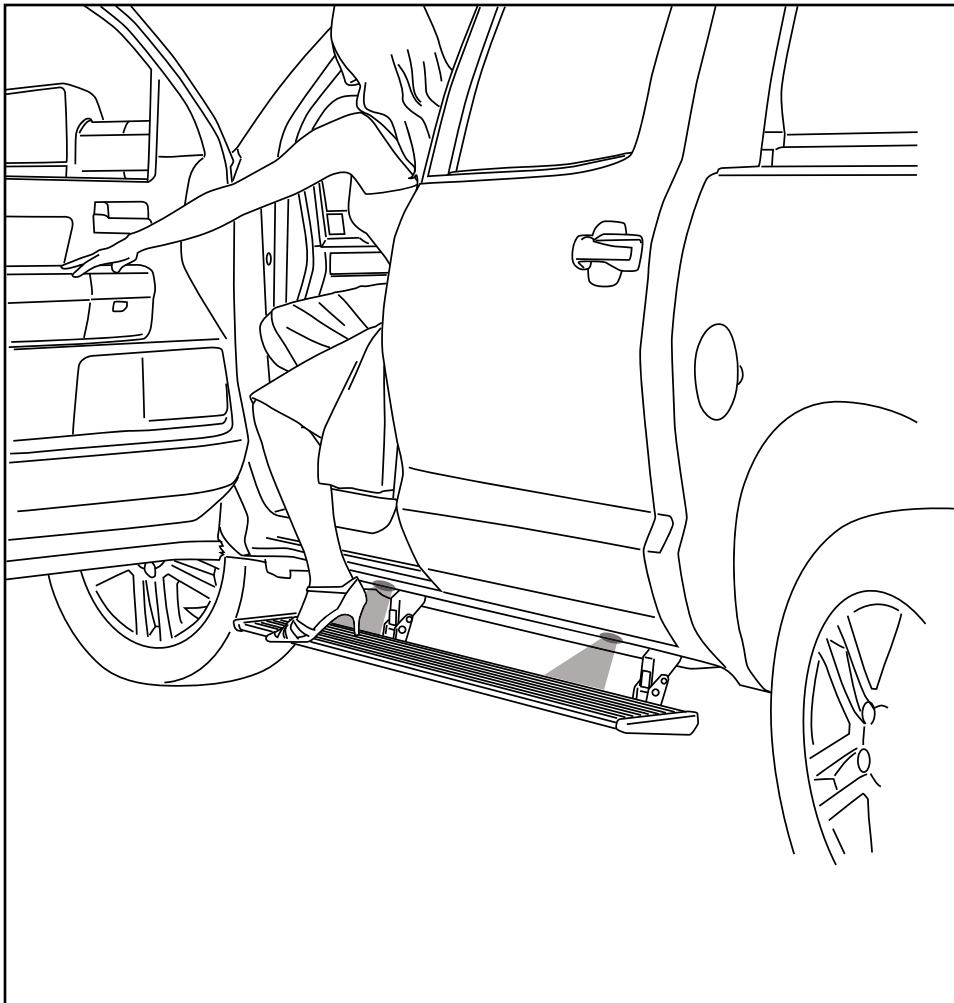

INSTALLATION TIME

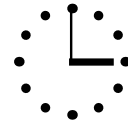

3:00 hrs

SKILL LEVEL



4= Experienced

TOOLS REQUIRED

- Measuring tape
- 13 mm socket
- 10 mm socket
- Ratchet wrench and extension
- 13mm end wrench
- Wire stripper / cutter
- 3/16" hex key wrench (allen wrench)
- 5mm hex key wrench (allen wrench)
- 4mm hex key wrench (allen wrench)
- Electrical tape

AMP RESEARCH TECH SUPPORT 1-888-983-2204 (Press 2) Monday - Friday, 6:00 AM - 5:00 PM PST

Designed and manufactured by AMP Research®. Patent Number 6,830,257; 6,641,158; 6,834,875; 6,938,909; 6,942,233; 7,007,961; 7,055,839; 7,163,221; 7,367,574; 7,380,807; 7,398,985; 7,413,204; 7,487,986. Other US and Worldwide patents pending. Made in USA © 2010 AMP Research
5-year limited warranty. Professional installation is recommended.

Note: Some Applications require modification.

Application	Cut Length
Crew Max	79" (No Modification Required)
Double Cab / Sequoia	63.5" (Trim 15.5")

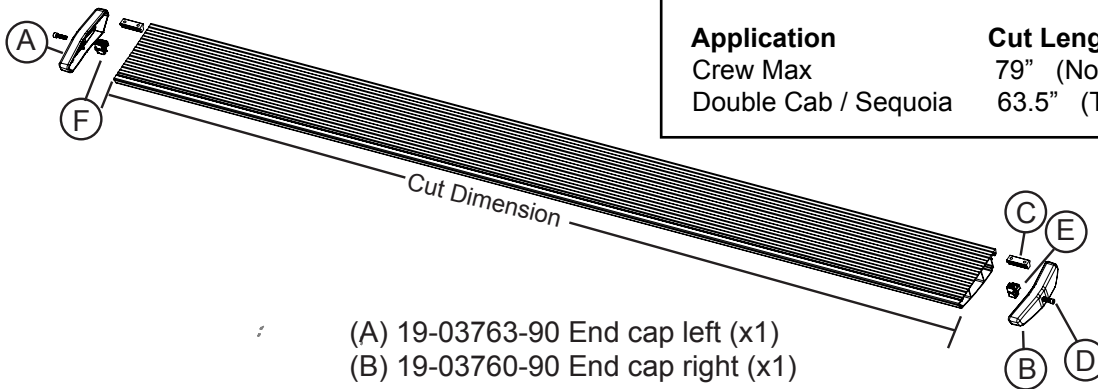

- (A) 19-03763-90 End cap left (x1)
- (B) 19-03760-90 End cap right (x1)
- (C) 19-02663-90 T-nut insert (x2)
- (D) 19-02802-90 Socket cap screw (x2)
- (E) 19-03761-90 End cap wedge right (x1)
- (F) 19-03764-90 End cap wedge left (x1)

1 x2

Running board assembly

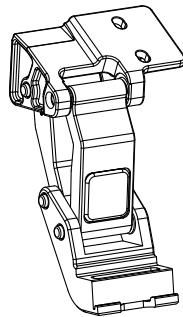

2 x2

10-03565-10
Idler linkage assembly

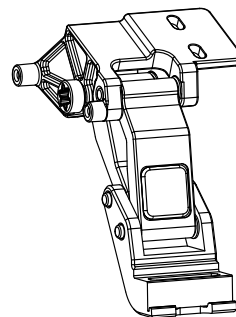

3 x2

10-03564-10
Motor linkage assembly

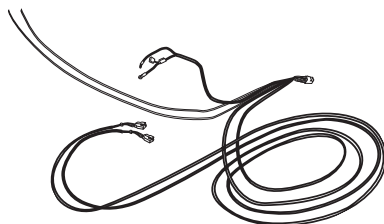

4

19-03568-91L
Wire harness

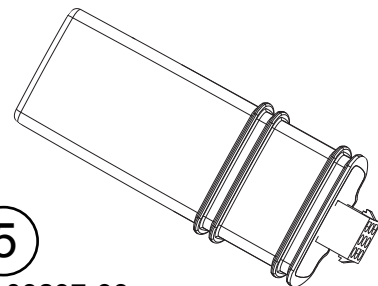

5

19-03297-93
Controller

AMP RESEARCH POWER STEP – TOYOTA TUNDRA / SEQUOIA

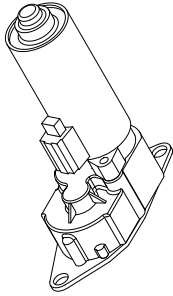

6 x2
19-03289-90
Motor

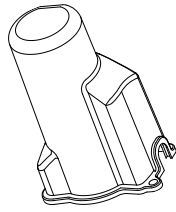

7 x2
19-03238-90
Motor Cover



8 x6
19-02721-90
Cinch Fastener

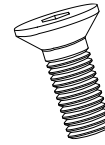

9 x4
19-03352-90
Socket Cap Screw

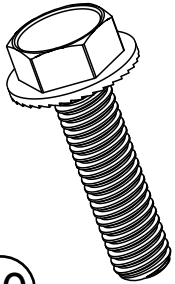

10 x8
19-03563-90
Hex Flange Bolt

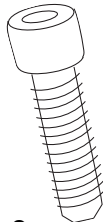

11 x8
19-02802-90
Socket Cap Screw

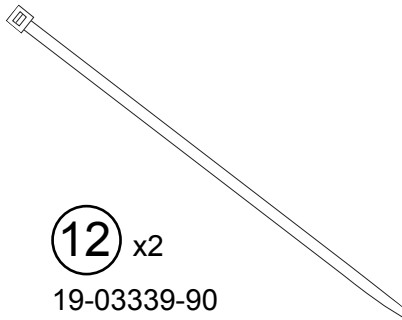

12 x2
19-03339-90
Cable tie (11")

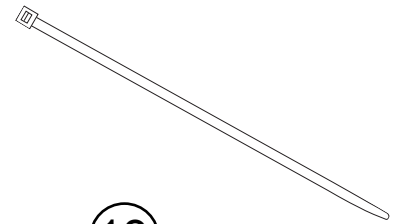

13 x20
19-02805-90
Cable tie (7")



14 x4
19-03354-90
Posi-Tap™

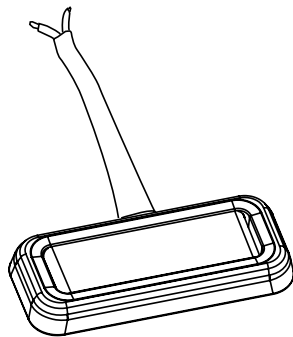

15 x4
19-03302-90
LED Lamp

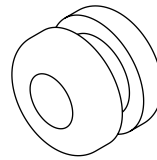

16 x4
19-02640-90
Grommet

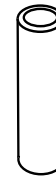

17 x8
19-02989-90
Butt Connector

**STEP 1 & 2 for CREW MAX ONLY.
All others skip to step 3**

Remove parking brake cable support from frame. Separate bracket and remove bracket from brake cable. Flip bracket 180 degrees to cable.

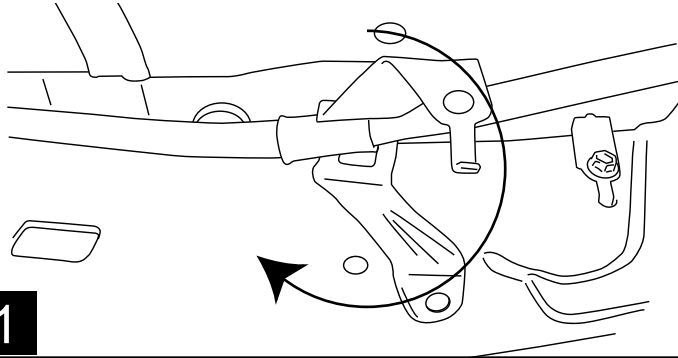

1

Secure parking brake cable support to frame so that the bolt is now below the cable.

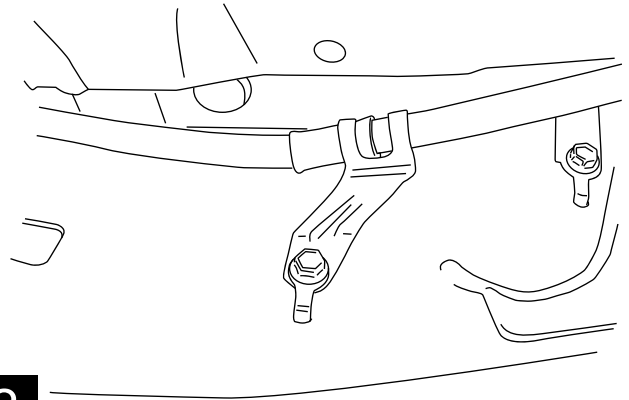

2

Slide motor assembly onto drive shaft and mounting bosses of driving linkage assembly. Use socket head cap screws (9) and tighten to 8 ft-lbs / 11Nm.

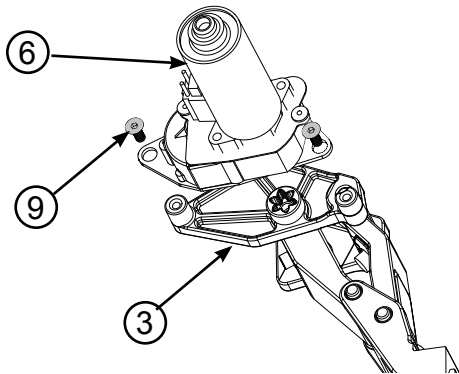

3

Install motor linkage on driver side in second set of factory running board holes from front. Use flange bolts (10) and torque to 22 ft-lbs / 30Nm.

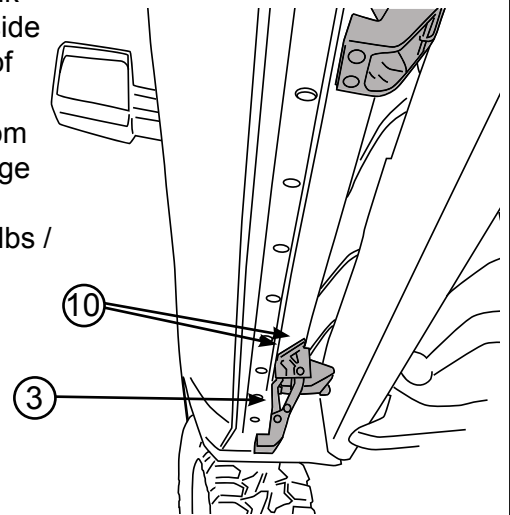

4

Install idler linkage in last set of factory running board holes from front. Use flange bolts (10) and torque to 22 ft-lbs / 30Nm.

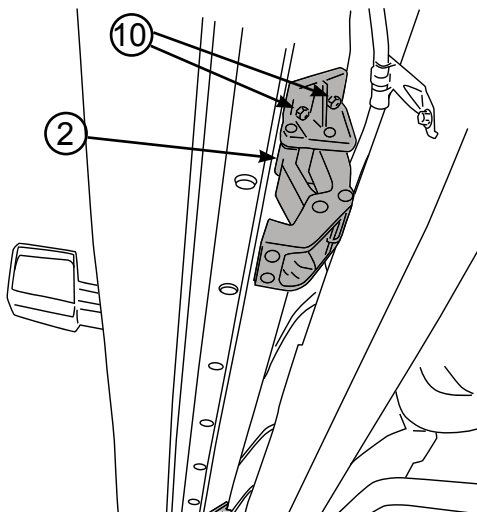

5

Repeat linkage installation on passenger side.

Install running board. See step 7 for alignment.

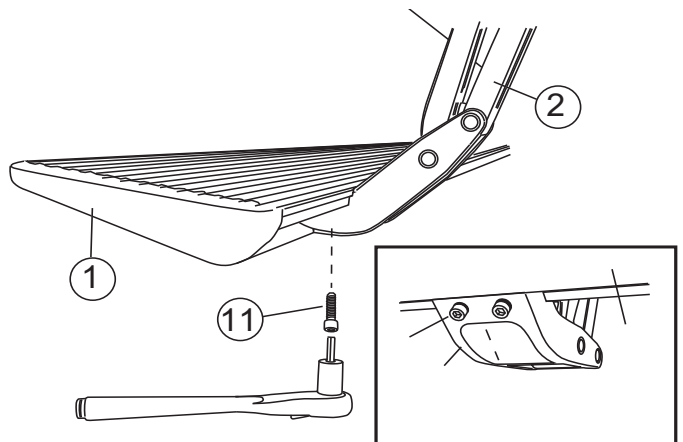

6

AMP RESEARCH POWER STEP – TOYOTA TUNDRA / SEQUOIA

Running board alignment.

Tundra:

Slide mounting T-nut into position. Align rear of running board with back edge of rear door.

Sequoia:

Slide mounting T-nut into position. Align rear of running board to the back edge of the cab.

Mount running board and tighten fasteners to 10 ft-lbs / 14Nm. Insure linkages are squared to body prior to torquing fasteners.

7

Install controller under hood on driver side fender apron. Secure to factory wiring loom with 11" cable ties. (3) (4)

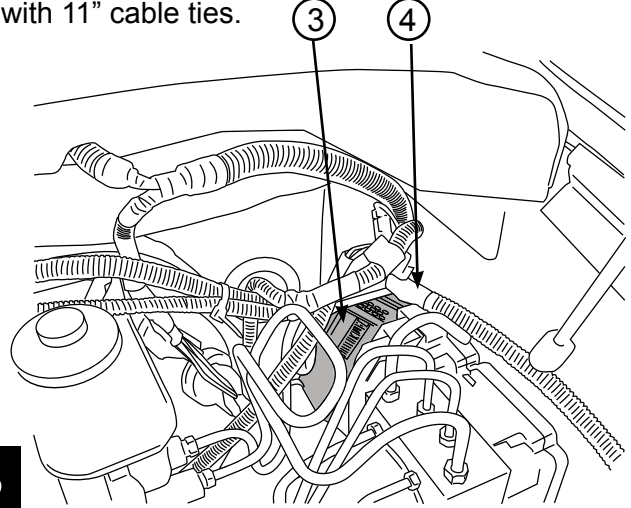

8

Remove power fuse. Connect wire harness to controller and secure locking clip. Connect red power lead to positive battery terminal and black ground lead to grounding lug on fender apron.

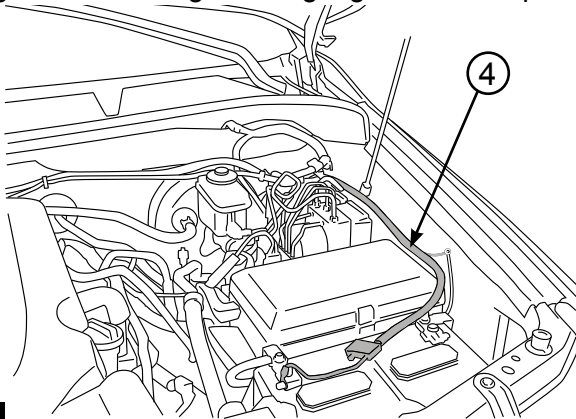

9

Route longest leg of wire harness across fire wall to passenger side and under vehicle outside of frame rail.

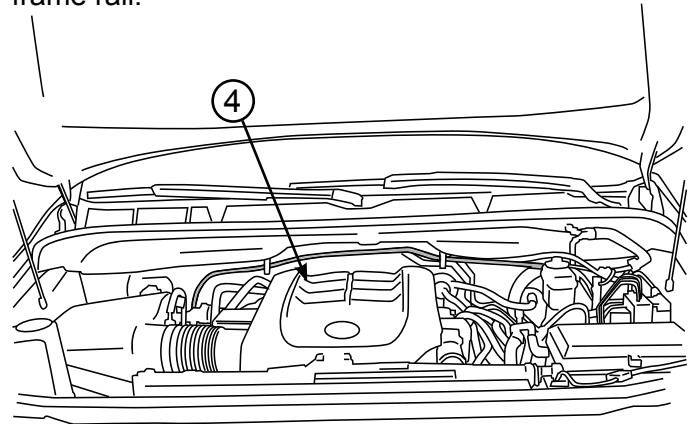

10

Route shorter leg of wire harness down driver side fender well and under vehicle outside of frame rail.

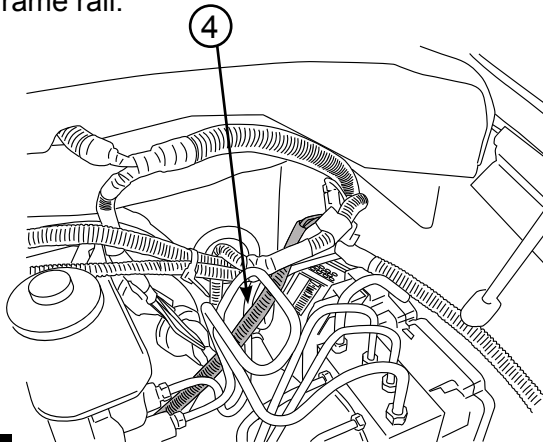

11

Remove driver and passenger front sill plates and kick panels. Pull up carpet. Locate rubber grommet under carpet in forward floorboard. Cut a slit in the rubber grommet and pass the trigger wires up through grommet under carpet to wire loom in door sill.

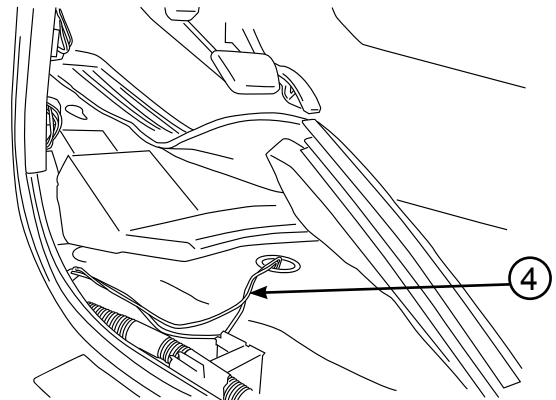

12

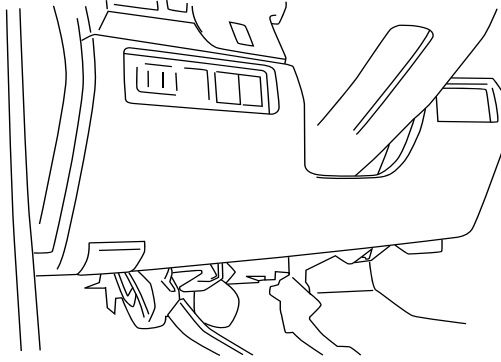

Remove trim panel below steering column

Posi-Tap™ instructions

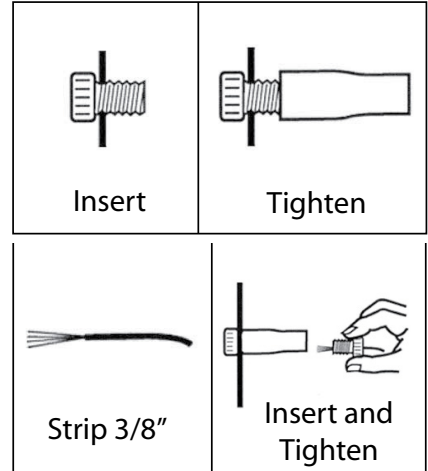

13

14

Locate main electrical junction box located under dash to the left of the steering column. Connect black Power Step wire to 18 gage charcoal wire (*Driver Rear*) in pin 2 of connector shown.

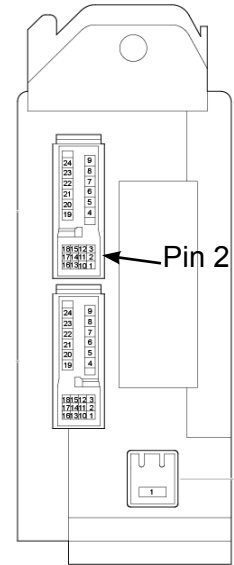
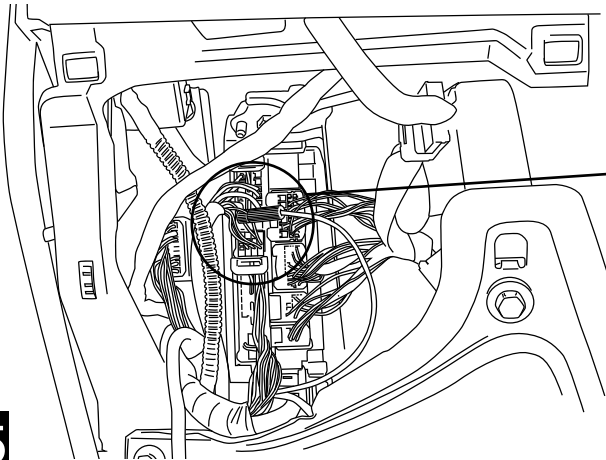

15

Locate black 20 pin connector at bottom of panel on left. Connect blue Power Step wire to 18 gage blue wire (*Driver Front*) in pin 15 of connector shown.

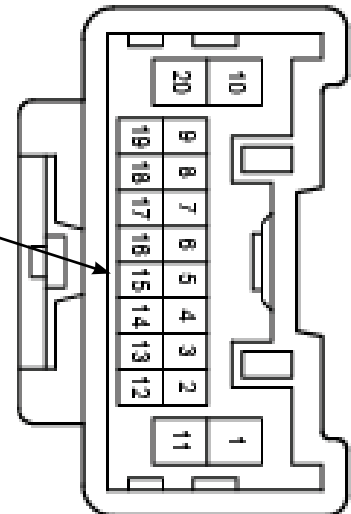
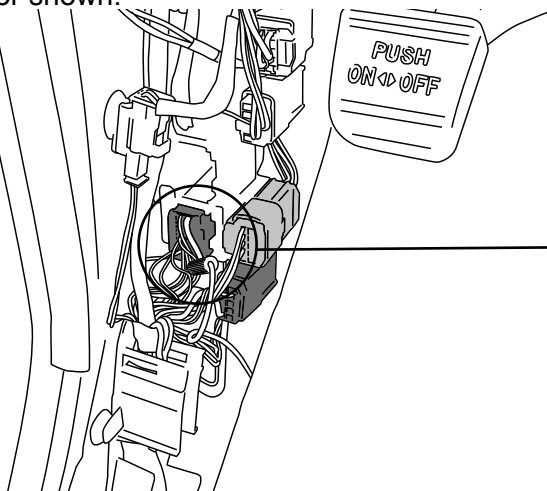

16

AMP RESEARCH POWER STEP – TOYOTA TUNDRA / SEQUOIA

Locate the grey 22 pin connector at the bottom of the passenger side kick panel area. Connect blue Power Step wire to 18 gage blue wire (*Passenger Rear*) in pin 1 and connect white Power Step wire to the 18 gage white wire (*Passenger Front*) in pin 9 of connector shown

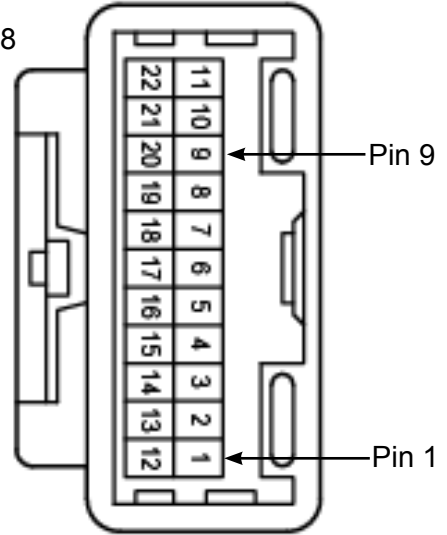
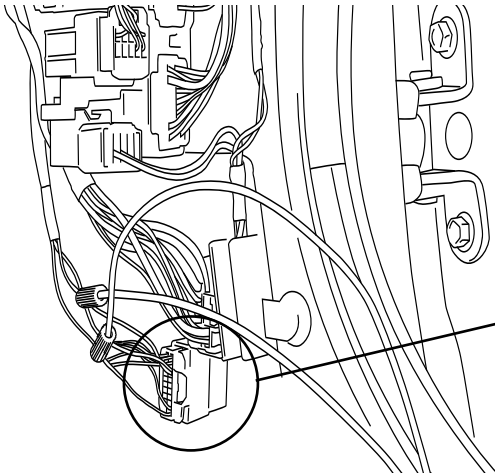

17

Insert plug from wire harness onto motor.

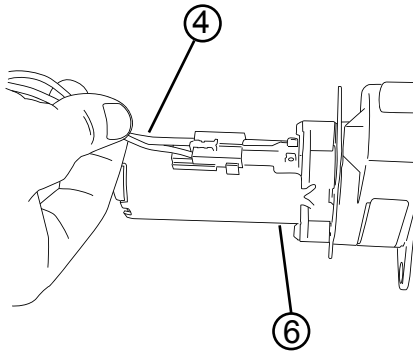

18

Slide rubber grommet on wire harness into slot of motor cover. Install motor cover onto motor.

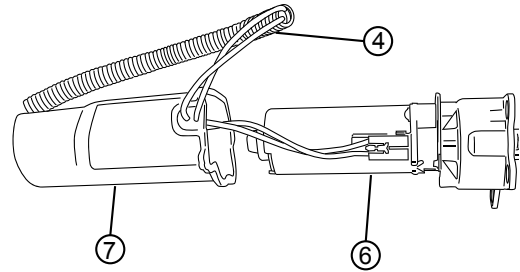

19

Partially separate the plastic rivet from the pin by bending the pin back and forth. Slide motor cover over motor and insert plastic push pin rivets in mounting holes of motor cover. Drive pin flush with rivet head. Use pliers to ease installation.

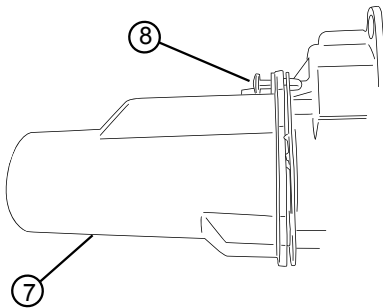

20

On each side of the vehicle measure from the front edge of door line on the pinch weld to the specified lengths below. Measure at 21" for front LED Light and 69" for rear LED Light.

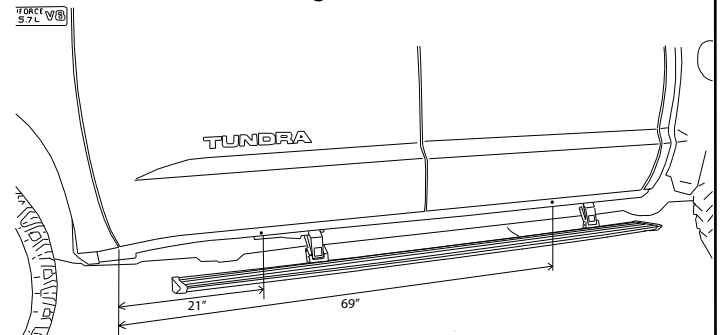

21

AMP RESEARCH POWER STEP – TOYOTA TUNDRA / SEQUOIA

Drill a 9/32" hole through the pinch weld at marked locations. Debur all holes.

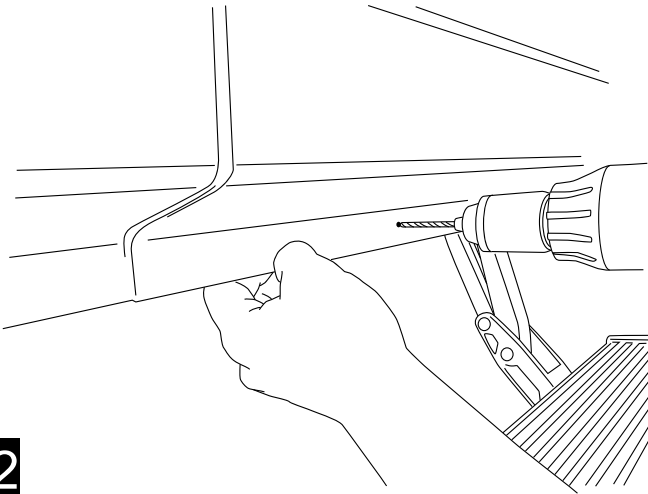

22

Insert grommet into drilled holes. Insert lamp wires through the grommets. (Silicon lube will help wires slip through grommets.)

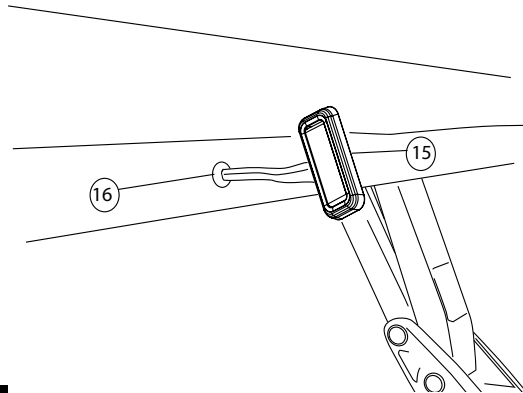

23

Affix lamp through rocker panel surface. Make sure lamp is affixed to a flat, clean surface.

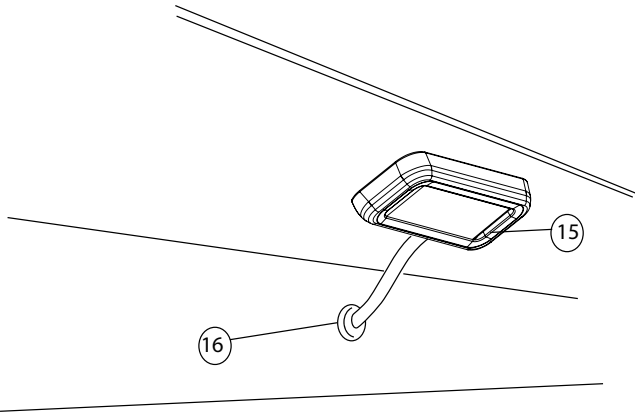

24

Using supplied butt connectors, connect the lamp wires. Red to Red, Black to Black.

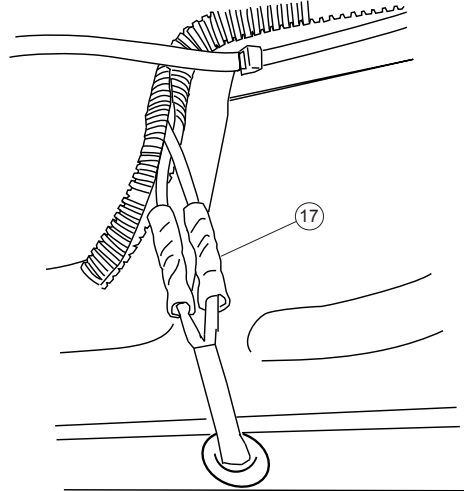

25

Close and wrap with conduit and electrical tape. Secure all loose wires with cable ties, with lamp wires pulled upward to avoid any wire snagging.

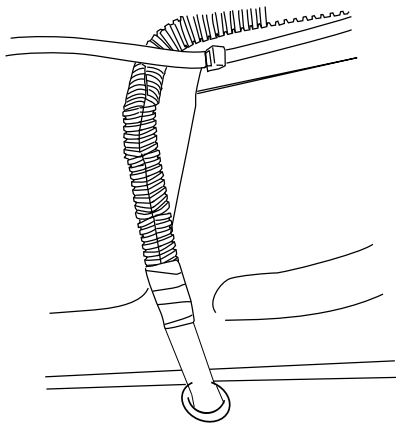

26

Reinstall fuse.

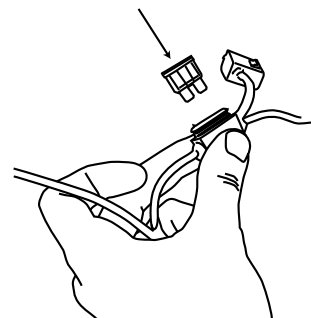

27

Check that all doors activate the Power Step and the LED Lights work when doors open and close. Reinstall any remaining trim panels.

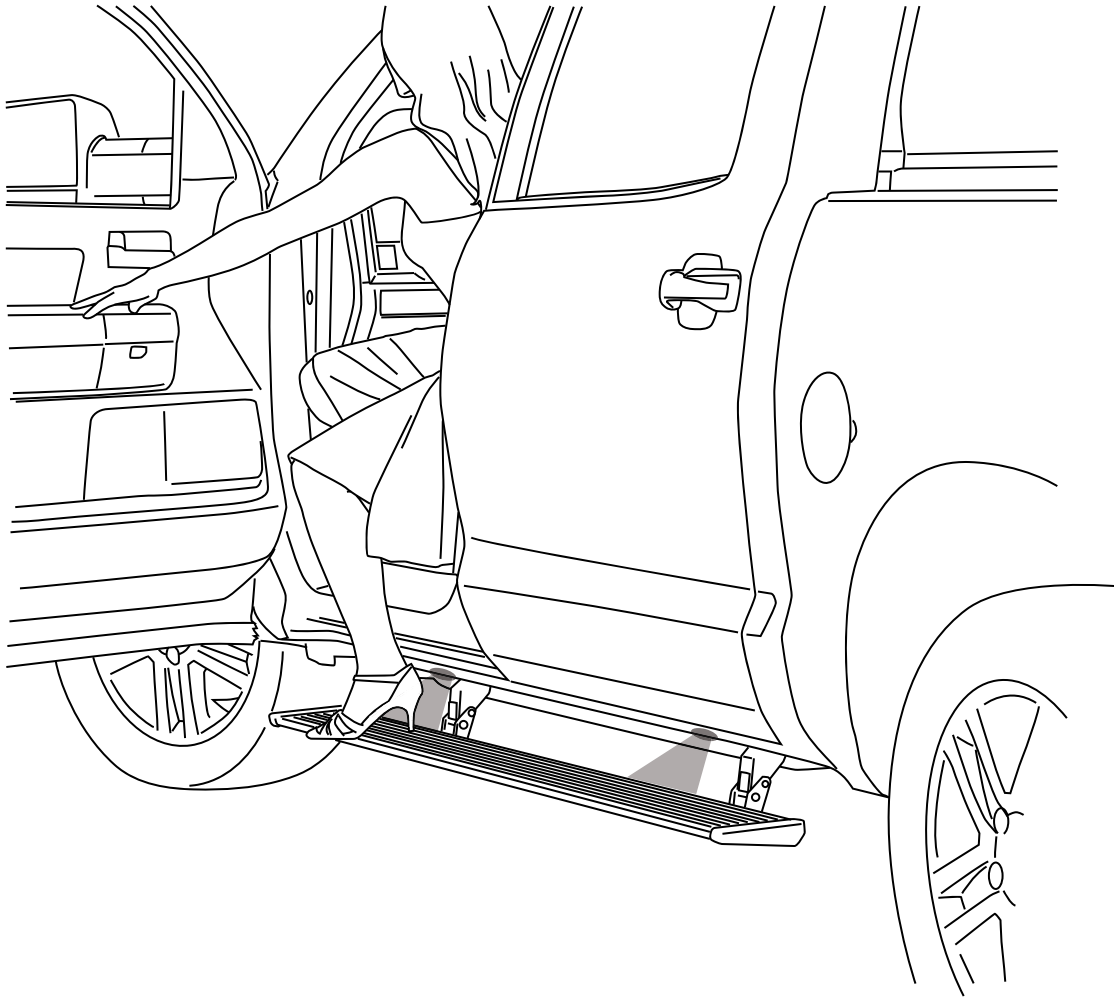

Correct operation of Lights: All four lamps will illuminate upon opening any door of vehicle. Lamps will stay on until restowing of both Power Steps or until 5 minutes has expired with the doors open. When the lights timeout after 5 minutes, they can be reilluminated by closing and opening any door of vehicle.

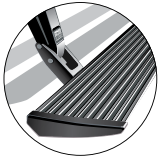

POWERSTEP™ OPERATION - The AMP Research PowerStep™ automatically deploys when any door is opened. When both front and rear doors are closed, it retracts automatically under your vehicle.

The drive system is designed to automatically stop if resistance, blockage or icing occurs.
To reset, clear any obstruction, then simply open and close the door and normal operation will resume.

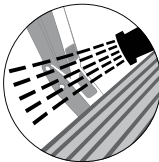

MAINTENANCE TIPS - The stepping surface and linkages should be periodically washed with mild soap and water using a soft brush or sponge to dislodge any mud, dirt or accumulated road grime.

In severe driving conditions, pressure washing the linkages is strongly recommended.

Avoid spraying the motors directly with high-pressure water. After washing, apply Silicone spray lubricant to the pivot pins of each linkage assembly. Remove any excess lubricant with a soft clean cloth. Do not apply Silicone spray, waxes or protectants like Armor All® to the stepping surfaces.



KEEPING POWERSTEP™ DEPLOYED - When washing your vehicle, the PowerStep can be set to remain in the deployed position with the doors closed. **DO THIS...**

1. With the PowerStep deployed, firmly press and hold the step down with your foot.
2. Close the door while continuing to press down on the step. *(This will not harm the motor.)*
3. To resume normal operation, simply open and close the door. *(Repeat for both sides of the vehicle.)*

CAUTION! KEEP HANDS AWAY WHEN THE POWERSTEP IS IN MOTION

AMP RESEARCH LIMITED WARRANTY

AMP RESEARCH warrants this product to be free from defects in material and workmanship for FIVE (5) YEARS FROM DATE OF PURCHASE, provided there has been normal use and proper maintenance. This warranty applies to the original purchaser only. All remedies under this warranty are limited to the repair replacement of the product itself, or the repair or replacement of any component part thereof, found by the factory to be defective within the time period specified. The decision to repair or replace is wholly within the discretion of the manufacturer.

This warranty specifically excludes labor. If you have a warranty claim, first you must call our factory at the number below for instructions. You must retain proof of purchase and submit a copy with any items returned for warranty work. Upon completion of warranty work, if any, we will return the repaired or replaced item or items to you freight prepaid. Damage to our products caused by accidents, fire, vandalism, negligence, misinstallation, misuse, Acts of God, or by defective parts not manufactured by us, is not covered under this warranty.

ANY IMPLIED WARRANTIES OF MERCHANTABILITY AND/OR FITNESS FOR A PARTICULAR PURPOSE CREATED HEREBY ARE LIMITED IN DURATION TO THE SAME DURATION AND SCOPE AS THE EXPRESS WRITTEN WARRANTY. OUR COMPANY SHALL NOT BE LIABLE FOR ANY INCIDENTAL OR CONSEQUENTIAL DAMAGE.

Some states do not allow limitations on how long an implied warranty lasts, or the exclusion or limitation of incidental or consequential damages, so the above limitations or exclusions may not apply to you. This warranty gives you specific legal rights, and you may also have other rights that vary from state to state.

FOR WARRANTY ISSUES WITH THIS PRODUCT PLEASE CALL AMP RESEARCH CUSTOMER SERVICE 1-800-315-9697

WARNING

Be sure to read and precisely follow the provided instructions when installing this product. Failure to do so could place the vehicle occupants in a potentially dangerous situation. After installing or reinstalling, re-check to insure that the product is properly installed.